

1980

Student Handbook, 1980-1981

George Fox University Archives

Follow this and additional works at: https://digitalcommons.georgefox.edu/student_handbooks

Recommended Citation

George Fox University Archives, "Student Handbook, 1980-1981" (1980). *Student Handbooks*. 26.
https://digitalcommons.georgefox.edu/student_handbooks/26

This Book is brought to you for free and open access by the Archives and Museum at Digital Commons @ George Fox University. It has been accepted for inclusion in Student Handbooks by an authorized administrator of Digital Commons @ George Fox University. For more information, please contact arolfe@georgefox.edu.

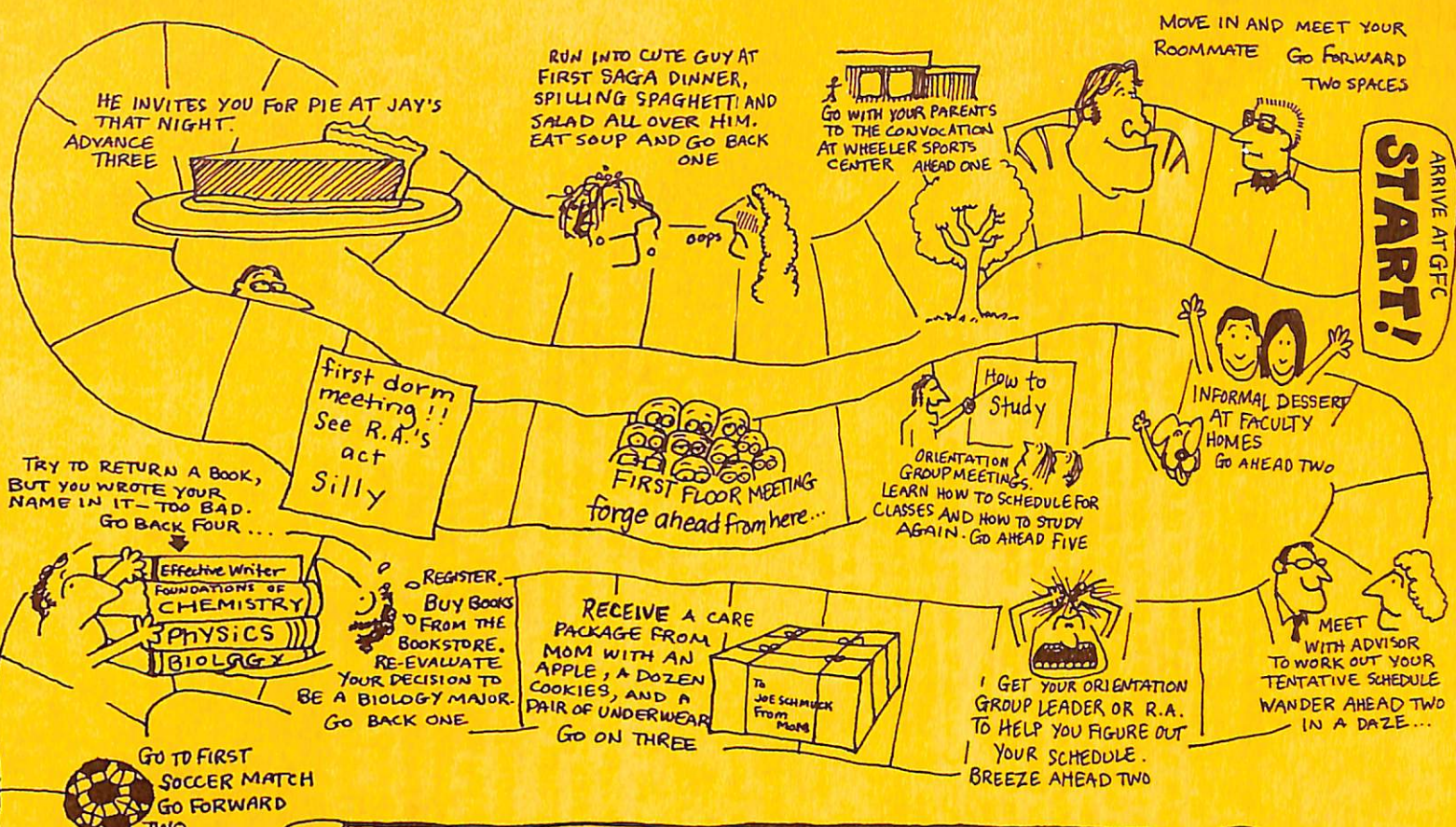

The First Resort 1980-1981

GEORGE FOX COLLEGE

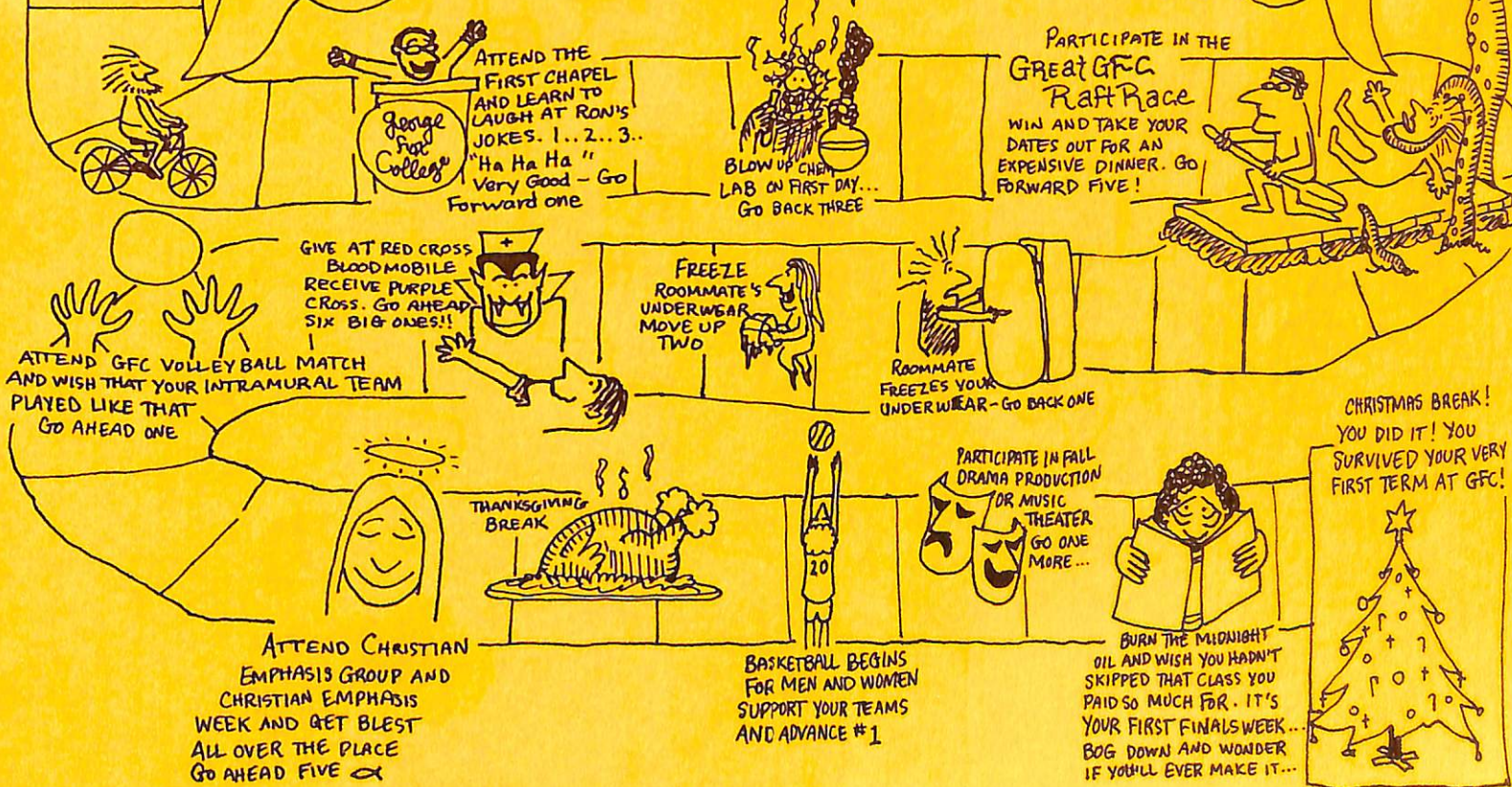

and this is only the beginning...

OCTOBER

"Let everything that hath breath praise the Lord!"

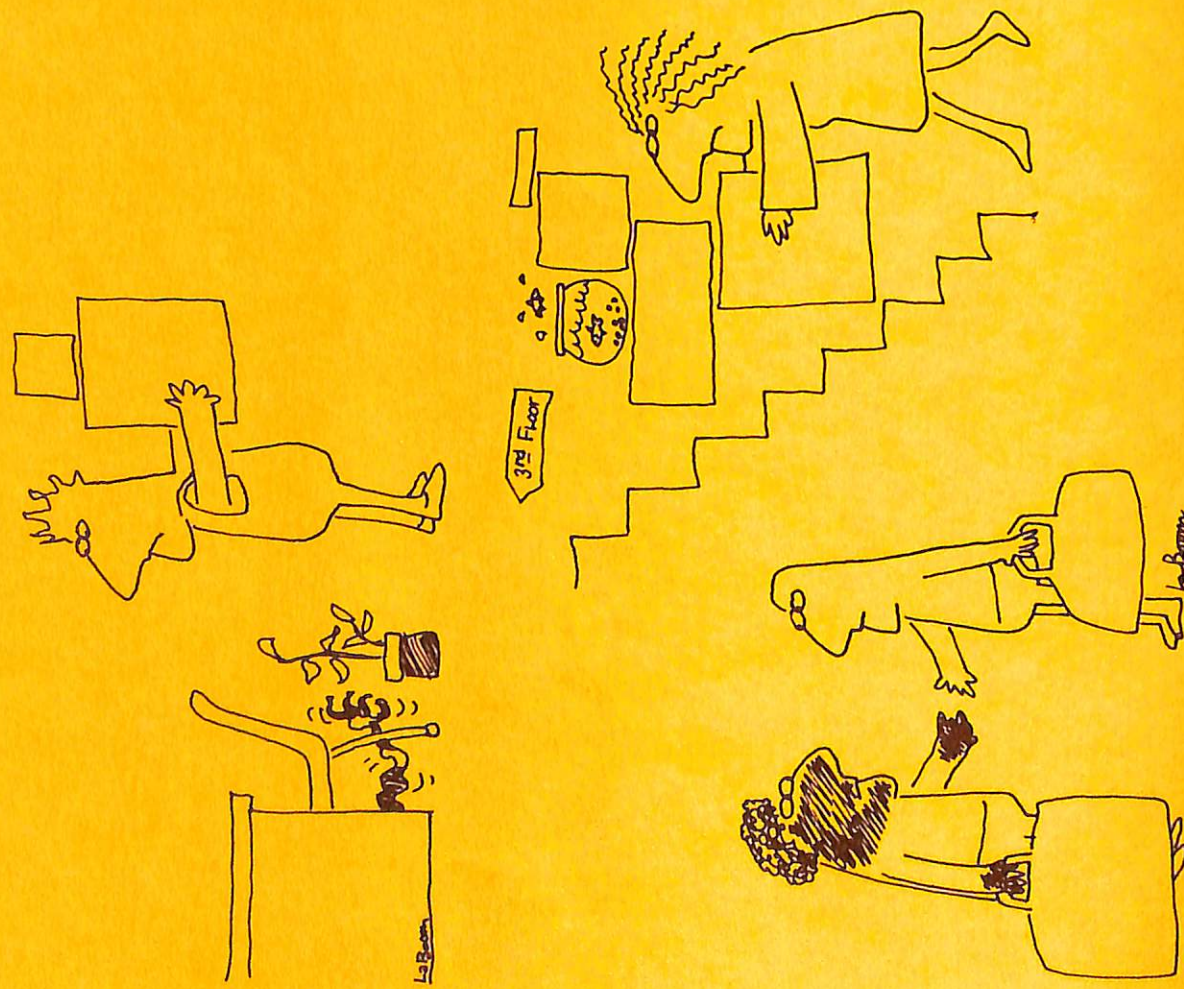

George Fox College is a learning environment where people can build a life plan. Education occurs whenever and wherever experiences contribute to human development. The integration of faith, Scripture, and learning is a primary objective of the College.

George Fox College is firmly committed to biblical principles. Spiritual growth is encouraged through several opportunities for on-campus Christian fellowship, such as discipleship groups that follow the Navigators' program; individual Bible study groups that develop on floors or between friends; Celebration on Sunday nights, which includes singing, sharing, speakers, films; and occasional guest speakers in classes.

Mandatory Chapel-Assembly programs are an integral part of the College's educational program. Chapel-Assembly is not just worship or spiritual experiences, but an experience that attempts to integrate what is happening to students into how they are living. It is a place of dialogue and encounter as well as a time to be challenged and to explore new areas of thought.

Residential Life

Student housing at GFC is an integral educational part of the college experience. The residence communities provide unique and meaningful experiences in human relations along with various opportunities to discover one's potential, self-worth, and philosophy of life. The various physical environments of the residence halls, houses, and apartments provide challenging opportunities for individual growth and development while maintaining a common bond of college residency.

All unmarried full-time (12 hours or more per term) students except those living with their parents or guardians are required to live in college-owned housing. Petitions to move into off-campus housing shall be evaluated on the basis of the length of time the student has been enrolled at George Fox College and the length of time the student has lived independently of his/her parents. Further information may be obtained from the Associate Director of Student Life. Petition requests must be filed two weeks prior to the end of the term.

Each residence community is staffed by a Resident Director who lives in and directs the living-learning program within each residence community. The director is a teacher, counselor, advisor, and friend, all rolled into one person. Each subcommunity (floor, wing, apartment area) within a residence community has a Resident Assistant who is there to be a friend and helper in any way possible. Your living-learning experience should be personally rewarding.

SEPTEMBER

- 24 S: Linfield, (T) 4:00 p.m.
- 27 S: Willamette, (T) 2:00 p.m.
- 28 Residence Halls open to new students, Noon
- 28-Oct 1 New Student Orientation
- 29-30 Student Government Retreat
- 30 Residence Halls open to returning students, 2:00 p.m.

Celebration, 9:00 p.m.

Fall Honors
Convocation, Miller
Gym
Dedication of Carey
Hall
VB: Linfield, (T)
7:00 p.m.

VB: Willamette, (H)
7:00 p.m.
Fall Christian Life Meetings

VB: Pacific, (H)
7:00 p.m.

1

2

3

4

VB: Western Baptist, (T)
7:00 p.m.
Classes begin

ASCGFC:
Scott Wesley Brown/
Fireworks Concert

Film, *Superman*
S: NNC, (H) 2:00 p.m.

5

6

7

8

9

10

11

VB: Pacific, (T)
7:00 p.m.
Sigma Zeta, 5:30 p.m.

Lyceum Series, Istvan
Nadas, 8:00 p.m.

VB: NNC Invitational
SIMA workshop
Band Retreat
S: OCE, (T) 2:00 p.m.

12

13

14

15

16

17

18

Celebration

VB: Mt. Hood, (H)
7:00 p.m.

Red Cross Bloodmobile
S: Warner Pacific,
4:00 p.m.
Sigma Zeta, 5:30 p.m.

VB: Concordia, (T)
7:00 p.m.

Film, *The Electric
Horseman*

Raft Race: ASCGFC
S: Lewis & Clark, (H)
2:00 p.m.

19

20

21

22

23

24

25

VB: Lewis & Clark, (T)
7:00 p.m.
Sigma Zeta, 5:30 p.m.

VB: UPS, (T)
7:00 p.m.
S: Western Baptist, (H)
3:30 p.m.
Choir Retreat

VB: PLU, (T)
11:00 a.m.

Celebration

26

27

28

29

30

31

VB: Linfield, (H)
7:00 p.m.
S: Pacific, (H) 3:30 p.m.
Sigma Zeta, 5:30 p.m.

Lyceum Series, "Brother
Martin," 8:00 p.m.
ASCGFC
Halloween Activity

November

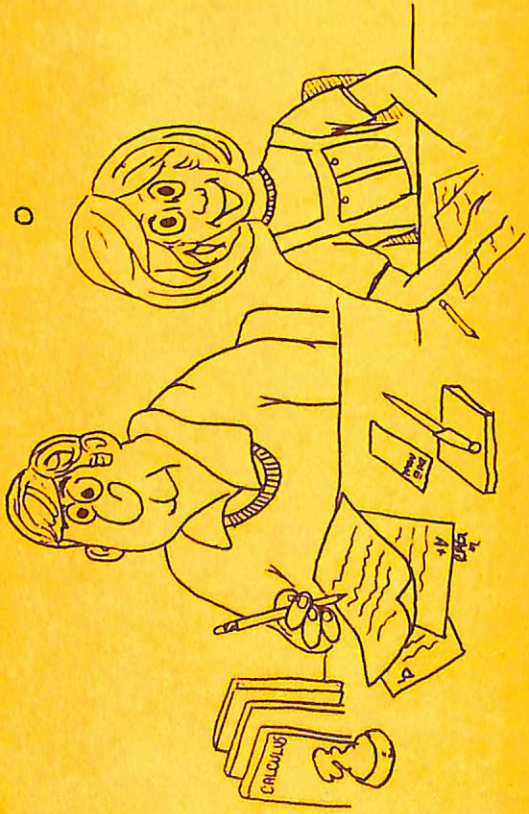
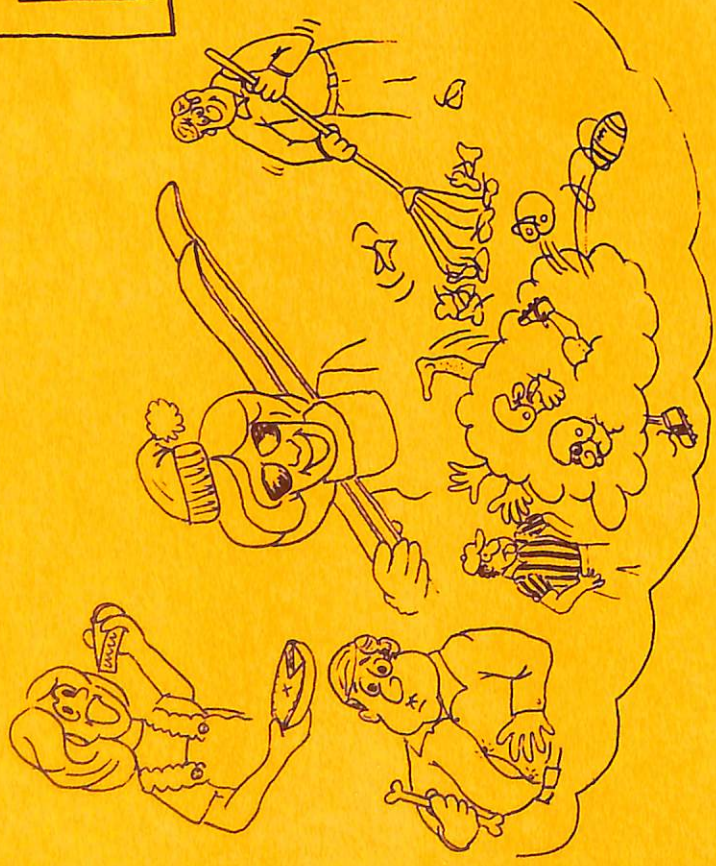

Hours

All freshmen and provisional students are to be in their residence unit by midnight Sunday through Thursday and by 2:00 a.m. on weekends (Friday and Saturday). Upperclass students are not required to follow these hours, but are encouraged to follow them. Doors to residence halls are locked at 11:00 p.m. Each residence hall resident has "late desk duty" approximately once a term to open the doors for residents coming in before 2:00 a.m.

Furnishings

You may alter the decor of your room or apartment provided changes have been approved through Student Life and the Business Office. No individual room refrigerators are permitted.

Storage

Articles stored must be boxed and clearly labeled with the name and permanent address of the owner. Articles will be kept no more than one term following a student's absence. Articles may be stored over the summer months when space is available. Preference is given to those students living out of state. Articles left in storage more than one term may be given away. Bicycles left at the end of the academic year may be stored by maintenance during the summer. There is a \$10 storage charge.

Room Changes

No room or unit changes are allowed the first two weeks of any term. If you wish to change rooms or units, obtain consent of your Resident Director.

Privacy

Your right to privacy will be respected. College personnel may enter a student's room or unit without notice only in emergencies where imminent danger to life, safety, health, or property is reasonably feared, or when there is suspicion or probable cause to believe that college regulations have been or are being violated. When the College seeks access to students' rooms or units to make repairs or improvements or for other necessary reasons, the occupants of the room or unit involved shall be notified of such action not less than 24 hours in advance, unless consent has been given. Requesting service or repairs shall be deemed giving consent to enter.

1

		MSU Retreat-----					
2	3	4	5	6	7	8	
Celebration -----		VB: Lewis & Clark, (H) 7:00 p.m.	VB: Willamette, (T) 7:00 p.m. Sigma Zeta, 5:30 p.m.	VB: Clark College, (T) 6:00 p.m.	Home Economics Career Day Film, <i>Just You and Me</i> , <i>Kid</i>		
9	10	11	12	13	14	15	
Celebration		Faculty Lecture: Genette McNichols VB: U of Portland, (T) 7:00 p.m.	VB: Judson Baptist, (T) 8:00 p.m. Sigma Zeta, 5:30 p.m. Quaker Emphasis Week-----	Seminary Day GFC Auxiliary Bazaar-----	Fall Drama Production, 8:00 p.m. Pops Concert, 7:30 p.m.		
16	17	18	19	20	21	22	
Celebration		Home Economics Workshop		Sigma Zeta, 5:30 p.m. Fall Drama Production, 8:00 p.m.-----			
23	24	25	26	27	28	29	
Celebration		Thanksgiving Vacation-----					
30							

Today
in the town of David
a Savior
has been born to you:
his
Christ the Lord

Luke 2:11

Christ the Lord

Lev. 2:11

Derma

Career Planning and Placement

This office assists students and alumni in making and implementing career decisions. In addition to providing career counseling, the CPCC compiles occupational information and graduate school information, and maintains placement files for students and alumni.

Registration, Advising, I.D. Cards

You are assigned an advisor for your initial registration to aid in planning course work. You may change your advisor, but it is your responsibility to notify the Registrar's Office of a change in your advisor or major. Each term the Registrar provides specific procedural information. After registration, financial arrangements are made in the Student Accounts Office. You may then obtain your identification card and receive official validation by the Student Life Office.

Soliciting

There is to be no soliciting on campus without approval from the Housing Office. For further information inquire at the Housing Office.

Automobiles and Bicycles

There are no restrictions on the use of automobiles as long as all traffic regulations are obeyed and proper insurance coverage is maintained. Students are required to register vehicles with the Maintenance Office and to abide by the College's parking policy. Due to a short supply of parking spaces for commuting students, resident students are asked not to drive to classes. A decal with registration numbers will be given to the registrant, who must display it on the left rear bumper (driver's side). The registrant is responsible for his/her vehicle at all times—this applies to leaving an auto unattended in NO PARKING areas. Bicycling is popular. Edwards, Hobson, Macy, Sutton, and Pennington Halls have covered bicycle racks. Repair shops are close to campus.

1	2	3	4	5	6
7	8	9	10	11	12
13	14	15	16	17	18
19	20	21	22	23	24
25	26	27	28	29	30
31	32	33	34	35	36

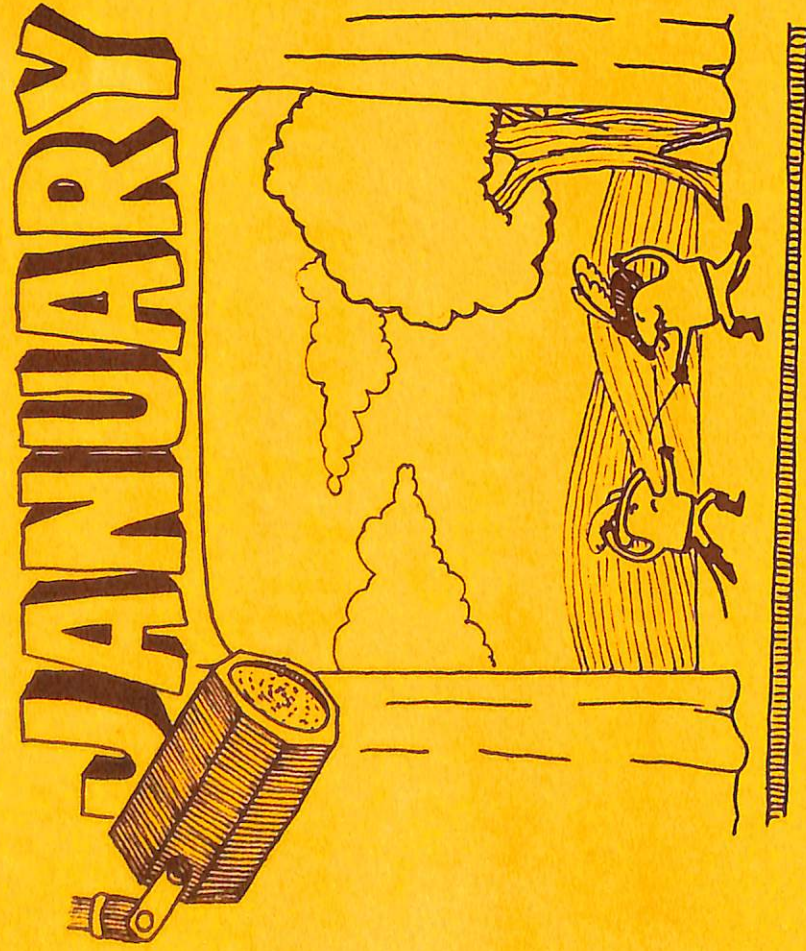

Student Records and Confidentiality

The federal Family Educational Rights and Privacy Act of 1974 allows students to inspect their educational records and provides guidelines on the release of personally identifiable information to third parties (grades, transcripts, career planning information). Records of school officials that are in the sole possession of the maker thereof, and that are not accessible to any other person except a substitute, are not considered to be educational records and are exempt. Parents' confidential financial statements are not open to students.

Further information on the Family Educational Rights and Privacy Act of 1974 may be obtained in the Student Life Office.

Nondiscrimination

George Fox College does not discriminate on the basis of age, sex, handicap, race, color, or national origin in its education programs or activities, including employment, that it operates, and is required by Title IX of the Education Amendments of 1972 and Title VII of the Civil Rights Act of 1964 not to discriminate in such manner. Inquiries concerning Title IX may be referred to the Dean of the College or the Dean of Students.

Financial Aid

George Fox College maintains the principle that every qualified student should be able to choose the college that would most greatly benefit him or her personally, without being hindered by financial limitations. Student financial aid serves to meet a student's NEED, which is defined as the difference between what a student (in the case of an independent student) or a student's family (in the case of a dependent student) can reasonably afford to pay and the total cost of an education. Each student seeking financial assistance must submit a copy of the Financial Aid Form (FAF), which both dependent and independent students may use. This form is a service of the College Scholarship Service (CSS), and its purpose is to assist colleges in determining the student's need for financial aid.

By submitting an FAF and requesting a report to be sent to George Fox College, a student indicates an interest in being considered for all forms of aid for which he or she qualifies. No other application for aid is necessary. Students will be considered for "no-need" forms for aid without filing an FAF. Students must reapply for financial aid each year by submitting the FAF.

1 2 3

BB: OOE, (T) 7:30 p.m. BB: Lewis & Clark, (T) 7:30 p.m.

8 9 10

Residence Halls open, 1:00 p.m. Classes begin WBB: U of Portland, (T) 5:30 p.m.

Sigma Zeta, 5:30

11 12 13 14 15 16 17

Celebration Lyceum Trio Concert 8:00 p.m.

WBB: Lewis & Clark, (H) 7:00 p.m. Sigma Zeta, 5:30 p.m.

BB: Warner Pacific, (T) 7:30 p.m. WBB: Multnomah, (T) 6:00 p.m. BB: Pacific U, (H) 7:30 p.m. Film, *China Syndrome*

18 19 20 21 22 23 24

Celebration

WBB: Pacific U, (T) 7:00 p.m.

Red Cross Bloodmobile Music Theater Production

GFC Auxillary meeting, 1:30 p.m.

BB: Concordia, (T) 7:30 p.m. WBB: Willamette, (T) 5:30 p.m. BB: Willamette, (T) 7:30 p.m.

25 26 27 28 29 30 31

Celebration

BB: Lewis & Clark, TBA WBB: Willamette, TBA

Missions Conference

Ecotopia Brass Ensemble Concert 8:00 p.m.

WBB: Linfield, (H) 7:00 p.m.

Film, *Camelot* BB: College of Idaho, (H) 7:30 p.m.

WBB: PLU (H), 12:00 noon

February



Telephone

After business hours students may use the college switchboard for outside calls. Incoming calls may be received 24 hours per day. Pay phones are located throughout the campus, from which all collect calls should be made. *Please notify the switchboard of any out-of-order pay phones and the phone number.* A Portland line is available after 5:30 p.m. and on weekends for students to place calls to Portland at no charge to them. Calls to residence extensions should be made prior to midnight to minimize the disturbance to those whose rooms are near the phones.

Communication

To keep up-to-date on current happenings, changes, or additions on policy, etc., students are expected to apprise themselves of the information contained in the *Bulletin*, published three times a week. Other on-campus communications include the student newspaper (*The Crescent*), the campus radio station (*KGFC*), the college directory (*The Bruin*), and the yearbook (*L'Ami*).

Post office boxes and keys are assigned to each student during registration. Replacement keys cost \$2.

Withdrawal from School

If you find it necessary to withdraw from school, follow the procedure below:

1. Obtain withdrawal form from the Registrar.
2. Complete exit interview.
3. Obtain required approval with appropriate signatures and dates.
4. Take withdrawal form to the Student Accounts Office, whereby the refund amount will be determined.
5. Report to the Registrar for final approval.

Withdrawal during a term results in financial penalty. Refunds are pro-rated; both the Student Accounts Office and Student Life Office have refund policy statements available upon request.

Pets

Only fish and turtles are allowed in residence housing.

1

2

3

4

5

6

7

Celebration

WBB: Judson, (H)
5:30 p.m.
BB: Concordia, (H)
7:30 p.m.

Sigma Zeta, 5:30 p.m.

Christian Ed Conference

BB: EOSC, (H) 7:30 p.m.
WBB: EOSC, (H)
5:30 p.m.
Drama Production

BB: NNC, (H) 7:30 p.m.
WBB: Western Baptist,
(T) 7:30 p.m.

8

9

10

11

12

13

14

Celebration

BB: Linfield, (T)
7:00 p.m.

Sigma Zeta, 5:30 p.m.

WBB: Lewis & Clark, (T)
7:00 p.m.

Film, *The Inlaws*

BB: NNC, (T) 7:30 p.m.
Married Students Retreat

BB: College of Idaho, (T)
WBB: St. Martin's, (H)
Home Ec Style Show,
2:00-4:00 p.m.
AAUW Senior Women's
Tea, 1:30 p.m.
Valentine Activity

15

16

17

18

19

20

21

Celebration

BB: EOSC, (T) 7:30 p.m.

WBB: Pacific (H)
7:00 p.m.

Sigma Zeta, 5:30 p.m.
A Cappella Choir Tour

BB: Western Baptist, (H)
7:30 p.m.
WBB: OIT, (H) 5:30 p.m.
Homecoming

BB: Warner Pacific, (H)
7:30 p.m.

22

23

24

25

26

27

28

Celebration

William Harness,
8:00 p.m.

Sigma Zeta, 5:30 p.m.

WBB: Concordia, (H)

Winter Drama, 8:00 p.m.
BB: District Playoffs
New Vision Singers Mini Tour

Christian Social
Involvement Day
WBB: Seattle Pacific,
(H) 2:00 p.m.



MARCH

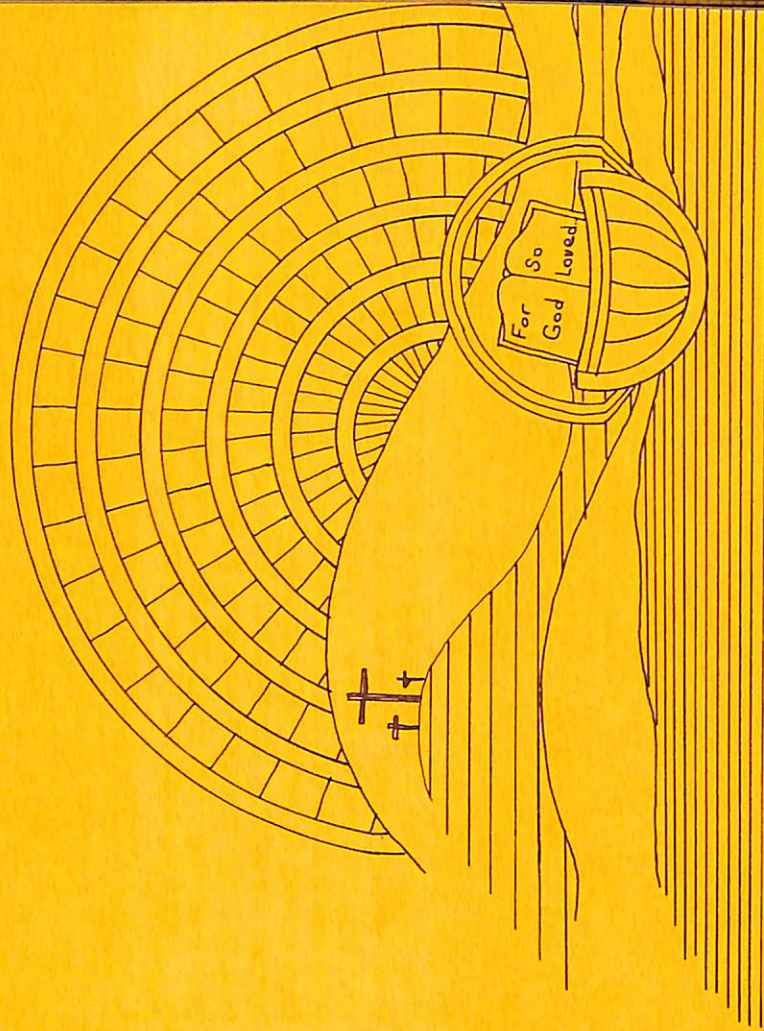

Food Service

All students who live in residence housing, with the exception of seniors (living in apartments or houses), are required to eat in Heacock Commons. Students have the option to purchase either 14 or 20 meals per week. SAGA Food Service, a contracted national food service company, provides cafeteria-type meals. There is always a variety of entrees available, plus vegetables, salad, desserts, and a wide choice of beverages. The meal schedule (subject to change) is as follows:

	Daily	Sat.	Sun.
Breakfast	7:15-8:00	Brunch	8:00-8:15
Lunch	12:00-1:30	10:30-11:30	12:15-1:15
Dinner	5:30-6:30	4:30-5:30	4:30-5:30

Guests

Two guest rooms are available at a minimal charge. Reservations can be made in the Business Office. Guests of students are the responsibility of the host/hostess and the visits are to be of short-term duration. All visitors are expected to leave at the closing hour unless special permission is granted by the Resident Director. Visits by prospective students should be arranged through the Admissions Office. No person of the opposite sex is to stay overnight in a student's room or apartment.

Health Services and Insurance

A part-time registered nurse is on duty providing consultation and treatment. She is available Monday through Friday from 9:00 a.m. to 1:00 p.m. No appointment is needed. When the nurse is not on duty the student should contact the Resident Director. However, the nurse is available "on call." Being in close contact with Newberg's physicians, the nurse makes arrangements with any doctor the student wishes. Insurance forms must be obtained before treatment by a physician.

A minimal amount of health and accident insurance is required of all students. This may be through the school insurance plan or a private policy. Insurance information is sent to the student prior to registration and is verified for adequate coverage by the nurse at the time of registration. Any questions concerning insurance should be directed to the Student Health Service Director.

Students are responsible for obtaining class excuses from the Health Service when ill by contacting the Health Service in person or by telephone (ext. 332) *during* their illness. It is the student's responsibility to know which professors require these excuses, usually when attendance affects the grade. Class excuses will not be given days or weeks afterward if the Health Service was not notified during the illness.

Personal property insurance can be arranged privately, but is not required. **THE COLLEGE DOES NOT TAKE RESPONSIBILITY FOR PERSONAL PROPERTY.**

1

2

3

4

5

6

7

Celebration

Chehalem Chamber Orchestra, 8:00 p.m.

Sigma Zeta, 5:30 p.m.

WBB: NCWA Div. III

Winter Drama Production

8

9

10

11

12

13

14

Celebration

Sigma Zeta, 5:30 p.m.

Residence Halls close, 11:00 a.m.
Band Tour

15

16

17

18

19

20

21

22

Residence Halls open, 1:00 p.m.
Celebration

23

24

25

26

27

28

29

Celebration
Choir Sunday

30

31

Staley Christian Scholar Series

Tears of Joy Puppet Company, 8:00 p.m.
GFC Auxiliary meeting, 1:30 p.m.
Film, *Kramer vs. Kramer*
John Perkins, Voice of Calvary, Black History Class

APRIL

1981

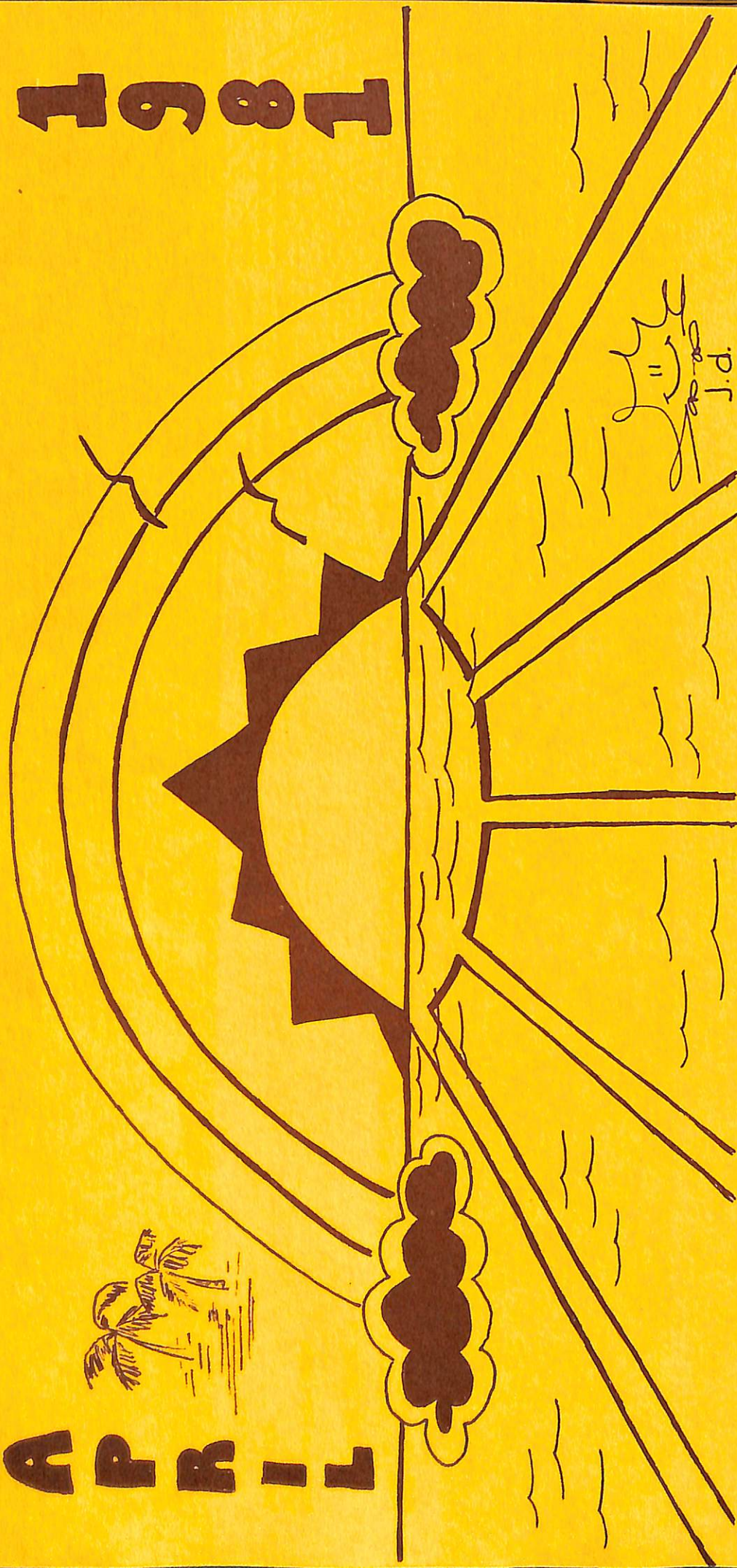

Activities/Student Government

There are many things to be learned in college, and some are best learned through involvement in productive activity that benefits the students of the college. Educational research has shown small colleges have proportionately more opportunities for "try it and see if you like it" involvement. George Fox College bears this out. There are many opportunities for involvement in student government, intramural and intercollegiate sports, discipleship groups, and various ad hoc groups formed to produce certain special events.

Plan to learn about your organizational and creative abilities by being a member of the newspaper staff, the Cultural Events Committee, or Spiritual Life Committee. Do not wait to get involved; explore your potential right away.

Bookstore

The George Fox College Bookstore, although open to the Newberg Community, functions primarily for students, faculty, and staff and their needs. Not only may texts be purchased, but also stationary, GFC garb, notebooks, candies, gifts, and a wide range of reading material. In addition to this, a film-developing and special-order service are available. Used books are bought back at the end of spring term, providing there is a market for them, and offered at prices in keeping with national used book pricing practices.

Banks

Three local banks in Newberg provide services: The Commercial Bank, U.S. National Bank of Oregon, and First National Bank of Oregon. In addition, there is a Benj. Franklin Savings and Loan Association office and a branch office of the First Federal Savings and Loan Association of McMinnville.

1

2

3

4

Staley Christian Scholar
cont.

John Perkins, Voice of
Calvary, Black History
Class

SIMA Workshop-----
Spotlight on Intermission-----

John Perkins, Voice of
Calvary, Black History
Class

5

6

7

8

9

10

11

Celebration

Sigma Zeta, 5:30 p.m.

Women's Awareness Conference-----

Red Cross Bloodmobile
Lyceum Series, Istvan
Nadas and Portland
Chamber Orchestra,
Mozart, 8:00 p.m.

Film, *Heroes*

Youth Choir Festival

12

13

14

15

16

17

18

Celebration

Sigma Zeta, 5:30 p.m.

Engaged Couples Mini
Retreat

Spring Drama Production, 8:00 p.m.-----

19

20

21

22

23

24

25

Celebration

Chehalem Chamber
Orchestra, 8:00 p.m.

Sigma Zeta, 5:30 p.m.

GFC Auxiliary meeting
Film, *Unidentified
Flying Oddball*,
7:30 p.m. and *North Ave.
Irregulars*, 9:30 p.m.
New Vision Singers Mini Tour-----

26

27

28

29

30

Celebration

Sigma Zeta, 5:30 p.m.

Spring Theological Conference, Dr. Carl Henry-----

May

If You Have a Problem

related to housing . . .

Talk things over with your Resident Assistant or Resident Director, or if you would prefer, talk with Mick Holsclaw (Associate Director of Student Life).

related to spiritual matters . . .

In addition to the people mentioned above, any staff or faculty person on campus will be glad to listen to your concerns and assist you with problems in this area. Ron Crecellus (Director of Christian Life) gives his full-time attention to this area.

related to career direction . . .

The Career Planning and Placement staff are trained to help students analyze their skills and interests to establish career directions.

related to academic program . . .

Dr. William Green (Dean of the College) is always ready to hear students' concerns in this area, but a more appropriate person to start with is your advisor, the faculty member teaching the course or the chairman of the division.

related to any other personal concern . . .

Lee Gerig (Dean of Students) and various members of the Student Life staff (nurse, chaplain, resident directors, associate director of student life, Career Planning and Financial Aid staffs) are all ready and willing to assist you in resolving problems that are standing in the way of your college goals. Talk to them, they can help!

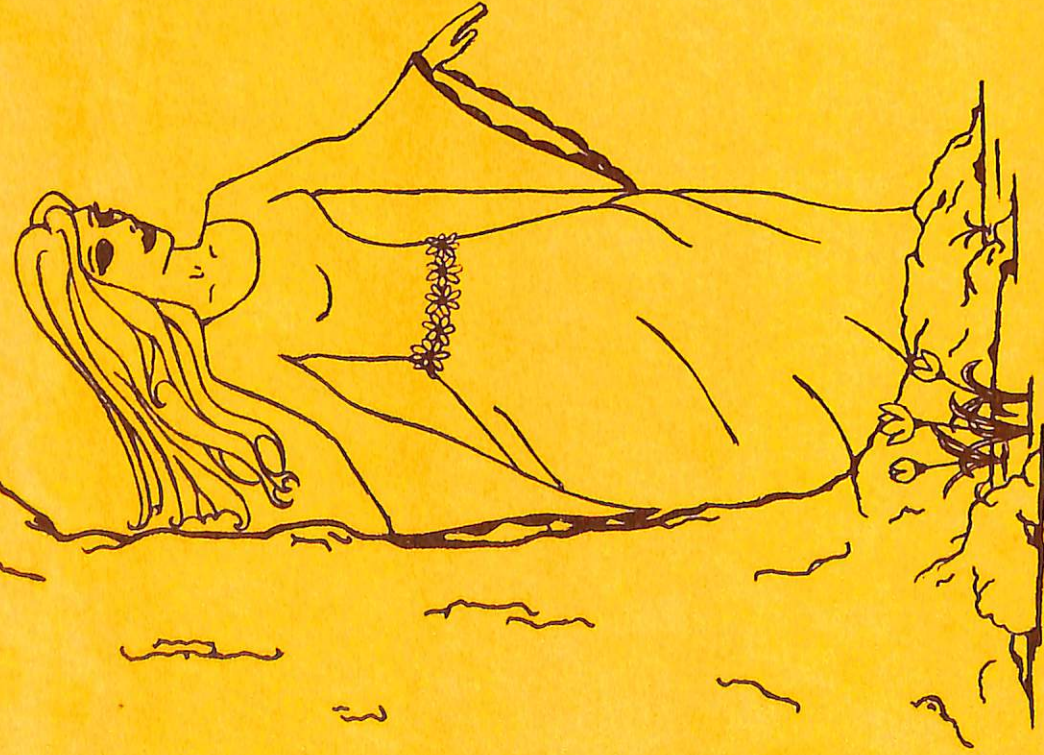

1 2

Music Theater, 8:00 p.m.-----
May Day Activity

8 9

New Vision Singers
Sunday
Celebration

Sigma Zeta, 5:30 p.m.

Music Theater, 8:00 p.m.-----

15 16

Celebration

Sigma Zeta, 5:30 p.m.

Film, *Seven Brides for
Seven Brothers*

22 23

Celebration

Sigma Zeta, 5:30 p.m.

Spring Concert,
8:00 p.m.
GFC Auxiliary
Luncheon, 1:30 p.m.
The Apocalypse, Readers Theater-----
Home Ec Barbecue

29 30

Celebration

31

Baccalaureate,
10:30 a.m.
Commencement,
2:00 p.m.
Residence Halls close,
5:00 p.m.

CONFRONTATION
PYRAMID*

The Confrontation Model of Discipline

“The Pyramid Concept”

All members of the campus at George Fox College share the responsibility for fulfilling and maintaining the community distinctives and life-style expectations. Nearly one third of the members of our community are new each year. Much information regarding community structure and expectations must be communicated to these new members in order to assimilate them into the community. Returning students, administration, faculty, student life personnel, and staff also need to be reminded of the GFC discipline model.

In the area of lifestyle expectations and discipline related to those expectations, the communication and confrontation process is visualized as a pyramid. This model is called a “pyramid approach to discipline” because many individuals are involved in the confrontation process with the student. This is in accord with the teachings of Scripture (Matthew 18:15-17, Luke 17:3-4, and James 5:19-20). As situations are dealt with and followed up, they rise through the pyramid until eventually the final decision regarding disciplinary action is made by a single person, the Dean of Students. Depending upon the nature of the violations of the community lifestyle expectations, *some situations rise immediately to the upper levels* of the pyramid while others may linger at lower levels. Yet, even a relatively minor offense (such as disruptive noisy behavior in residence halls) may result in suspension or dismissal if repeated occurrences in the face of counseling and confrontation demonstrate a serious negative attitude or a destructive impact upon the community.

When a George Fox student behaves in an unacceptable manner, a concerned individual should communicate the expectations of the college to the student as they relate to the observed behavior. If the behavior changes, the problem is resolved. Thus, we have the broad base of the pyramid with the two thirds of the community that is familiar with the structure and expectations of the community communicating to the one third that is new and unfamiliar with these expectations.

If the unacceptable behavior continues, the student is confronted once again, but with a third party as a witness. In the case of a student-to-student confrontation, the third party may be a Resident Assistant or Resident Director. In the case of a faculty/staff member-to-student confrontation, the third party may be another faculty/staff member or a Resident Director or other Student Life staff member.

*Depending upon the nature of the violations of the George Fox College Lifestyle expectations, *some situations rise immediately to the upper levels* of the pyramid while others may linger at lower levels.

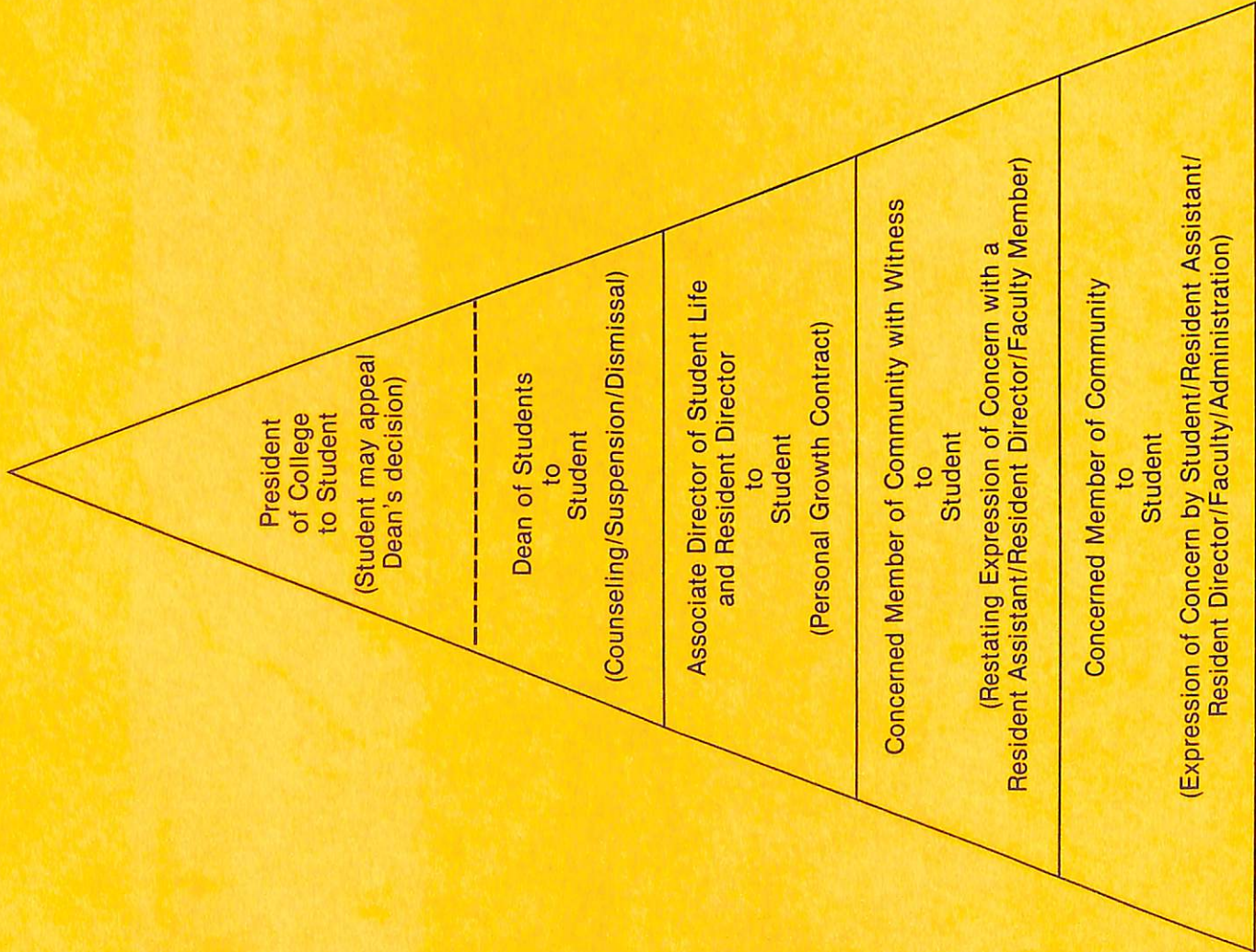

If the behavior persists, the Associate Director of Student Life and the Resident Director are involved to develop a personal growth contract with the student. Such a contract specifies what behaviors are in need of change and what kinds of changes are deemed beneficial. The contract is put in writing with both parties signing it. At this point the pyramid of confrontation and communication has narrowed to the point that few people are involved in the negotiation of personal growth contracts.

If a student fails to implement the terms of a personal growth contract, the Associate Director of Student Life presents the case to the Dean of Students, who then takes appropriate disciplinary action. The Dean then continues the ongoing counseling process with the student and discusses the case with those who have been involved in the confrontation process. The Dean and the student involved will work together to resolve the situation. Whatever the circumstances, however, action will be taken at this time. If the student is suspended or dismissed by the Dean of Students, he or she may appeal the Dean's disciplinary action to the President of the College.

Appeals to the President of the College must be made within two school days. All such appeals must be made in writing and submitted to the Office of the President of the College. The appeal shall consist of a statement of the facts that set forth one of the following exclusive grounds for appeal:

1. There is significant new evidence that has not yet been considered.
2. The discipline imposed was unreasonable.
3. The official(s) imposing the discipline was biased.

Upon review of the appeal, the President may take any of the following actions:

1. Affirm in whole or in part the findings and disciplinary action.
2. Reduce the severity of the disciplinary action.
3. Order a reconsideration of the case.

PROSCRIBED CONDUCT

Discipline administered by the College is limited to incidents of student misconduct that adversely affect the College community's pursuit of its educational objectives. Various types of misconduct for which students are subject to College discipline include the following:

1. All forms of dishonesty including cheating, plagiarism, knowingly furnishing false information to the institution, and forgery, alteration, or use of college documents or instruments of identification with intent to defraud. In addition, unauthorized possession or use of keys to the campus or parts of the campus is prima facie evidence of intent to violate campus regulations and may result in dismissal from the College. KEYS ARE NOT TO BE LOANED TO ANOTHER PERSON, USED BY ANOTHER PERSON, OR DUPLICATED.

2. Sexual Immorality. The College stands firmly upon the biblical principle that sexual intercourse should be confined to marriage. The college cannot create situations that foster permissiveness in the area of sexual relations. For this reason unauthorized intervisitation in students' rooms of the men's and women's residence halls is not permitted. Examples of sexual immorality include involvement in both premarital and extramarital sexual relationships, and in homosexual activities.

3. Gambling.

4. Unauthorized possession or use of firearms (including air rifles and air pistols), ammunition, or explosives in or upon College-owned or College-supervised property.

5. Violation of fire safety regulations. Any interference with the normal operation of a fire alarm system and/or inappropriate and unauthorized use of fire-fighting equipment is considered by the College to be extremely serious misconduct. Furthermore, students are not permitted to discharge any type of fireworks or explosives in and around buildings; tamper with a building's electrical system; burn incense or have open flames in rooms of residence halls; refuse or obstruct participation in regularly scheduled fire drills; nor use "open coil" appliances.

6. Misuse, sale, distribution, and possession of nonprescribed drugs and use of tobacco and alcohol.

7. Intentional disruption or obstruction of teaching, research, administration of disciplinary proceedings, or other college activities.

8. Physical abuse of any person on college premises or at college-sponsored or supervised functions.

9. Hazing or other initiations or actions hazardous, dehumanizing, or humiliating to students. A full policy statement is available in Student Life Office.

10. Theft from or damage to College premises or damage to property of a member of the College community or College premises.

11. Social Dancing. The College has determined that its interests are best served by not sponsoring dances and by not permitting social dancing on campus, or at college-related activities or events.

12. Failure to comply with directions of College officials acting in performance of their duties.

13. Violation of published College regulations including those related to entry and use of College facilities, the expectations found in the Student Handbook, and any other regulations that may be enacted.

14. Violation of law on or off College premises or in residence halls in a way that affects the College community's pursuit of its proper educational purposes.



NEWBERG, OREGON 97132

ART DESIGN: Mary Beck, Gail Bumala, Joyce
Davenport, Jennifer de Jesus, Ray George, Colleen
Howard, Ann Winters

EDITOR: Nancy Streight

ADVISOR: Mick Holsclaw